

青口汽车工业园区校园路道路工程项目勘测定界图
2867.4-40435.2

40435.96
2868.2

40435.16
2868.2

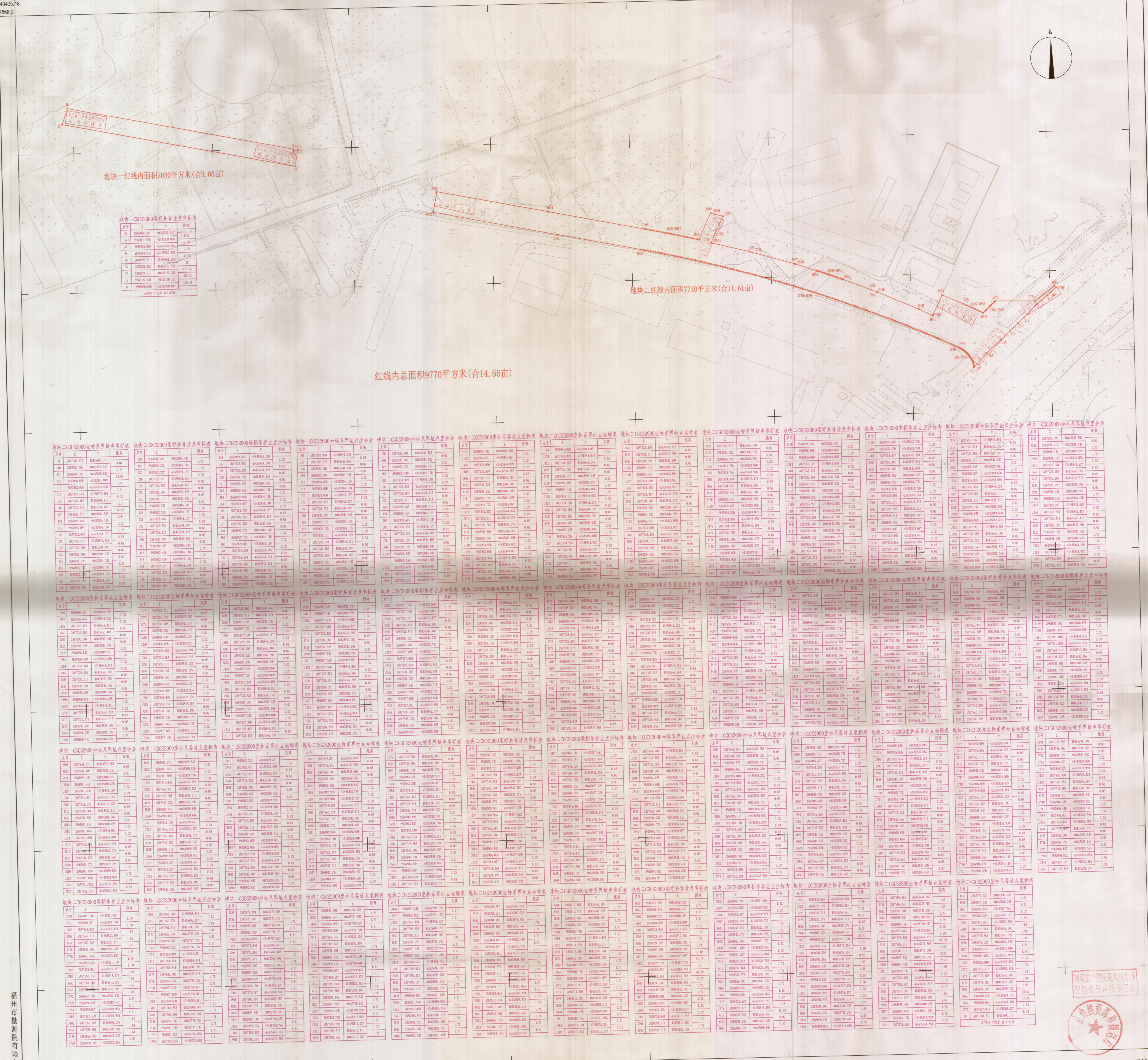

地块一红线内面积2030平方米(合3.05亩)

地块二红线内面积7740平方米(合11.61亩)

红线内总面积9770平方米(合14.66亩)

Table with 4 columns: 序号 (Serial Number), X (X-coordinate), Y (Y-coordinate), 面积 (Area). Lists parcel data for Block 1.

Table with 4 columns: 序号 (Serial Number), X (X-coordinate), Y (Y-coordinate), 面积 (Area). Lists parcel data for Block 2.

Table with 4 columns: 序号 (Serial Number), X (X-coordinate), Y (Y-coordinate), 面积 (Area). Lists parcel data for Block 2.

Table with 4 columns: 序号 (Serial Number), X (X-coordinate), Y (Y-coordinate), 面积 (Area). Lists parcel data for Block 2.

Table with 4 columns: 序号 (Serial Number), X (X-coordinate), Y (Y-coordinate), 面积 (Area). Lists parcel data for Block 2.

Table with 4 columns: 序号 (Serial Number), X (X-coordinate), Y (Y-coordinate), 面积 (Area). Lists parcel data for Block 2.

Table with 4 columns: 序号 (Serial Number), X (X-coordinate), Y (Y-coordinate), 面积 (Area). Lists parcel data for Block 2.

Table with 4 columns: 序号 (Serial Number), X (X-coordinate), Y (Y-coordinate), 面积 (Area). Lists parcel data for Block 2.

Table with 4 columns: 序号 (Serial Number), X (X-coordinate), Y (Y-coordinate), 面积 (Area). Lists parcel data for Block 2.

Table with 4 columns: 序号 (Serial Number), X (X-coordinate), Y (Y-coordinate), 面积 (Area). Lists parcel data for Block 2.

Table with 4 columns: 序号 (Serial Number), X (X-coordinate), Y (Y-coordinate), 面积 (Area). Lists parcel data for Block 2.

Table with 4 columns: 序号 (Serial Number), X (X-coordinate), Y (Y-coordinate), 面积 (Area). Lists parcel data for Block 2.

Table with 4 columns: 序号 (Serial Number), X (X-coordinate), Y (Y-coordinate), 面积 (Area). Lists parcel data for Block 2.

Table with 4 columns: 序号 (Serial Number), X (X-coordinate), Y (Y-coordinate), 面积 (Area). Lists parcel data for Block 2.

Table with 4 columns: 序号 (Serial Number), X (X-coordinate), Y (Y-coordinate), 面积 (Area). Lists parcel data for Block 2.

Table with 4 columns: 序号 (Serial Number), X (X-coordinate), Y (Y-coordinate), 面积 (Area). Lists parcel data for Block 2.

Table with 4 columns: 序号 (Serial Number), X (X-coordinate), Y (Y-coordinate), 面积 (Area). Lists parcel data for Block 2.

Table with 4 columns: 序号 (Serial Number), X (X-coordinate), Y (Y-coordinate), 面积 (Area). Lists parcel data for Block 2.

Table with 4 columns: 序号 (Serial Number), X (X-coordinate), Y (Y-coordinate), 面积 (Area). Lists parcel data for Block 2.

Table with 4 columns: 序号 (Serial Number), X (X-coordinate), Y (Y-coordinate), 面积 (Area). Lists parcel data for Block 2.

Table with 4 columns: 序号 (Serial Number), X (X-coordinate), Y (Y-coordinate), 面积 (Area). Lists parcel data for Block 2.

Table with 4 columns: 序号 (Serial Number), X (X-coordinate), Y (Y-coordinate), 面积 (Area). Lists parcel data for Block 2.

Table with 4 columns: 序号 (Serial Number), X (X-coordinate), Y (Y-coordinate), 面积 (Area). Lists parcel data for Block 2.

Table with 4 columns: 序号 (Serial Number), X (X-coordinate), Y (Y-coordinate), 面积 (Area). Lists parcel data for Block 2.

Table with 4 columns: 序号 (Serial Number), X (X-coordinate), Y (Y-coordinate), 面积 (Area). Lists parcel data for Block 2.

Table with 4 columns: 序号 (Serial Number), X (X-coordinate), Y (Y-coordinate), 面积 (Area). Lists parcel data for Block 2.

Table with 4 columns: 序号 (Serial Number), X (X-coordinate), Y (Y-coordinate), 面积 (Area). Lists parcel data for Block 2.

Table with 4 columns: 序号 (Serial Number), X (X-coordinate), Y (Y-coordinate), 面积 (Area). Lists parcel data for Block 2.

Table with 4 columns: 序号 (Serial Number), X (X-coordinate), Y (Y-coordinate), 面积 (Area). Lists parcel data for Block 2.

Table with 4 columns: 序号 (Serial Number), X (X-coordinate), Y (Y-coordinate), 面积 (Area). Lists parcel data for Block 2.

Table with 4 columns: 序号 (Serial Number), X (X-coordinate), Y (Y-coordinate), 面积 (Area). Lists parcel data for Block 2.

Table with 4 columns: 序号 (Serial Number), X (X-coordinate), Y (Y-coordinate), 面积 (Area). Lists parcel data for Block 2.

Table with 4 columns: 序号 (Serial Number), X (X-coordinate), Y (Y-coordinate), 面积 (Area). Lists parcel data for Block 2.

福州市勘测院有限公司

1867.44

40435.96

2021年1月全野外数字采集

CGS2000坐标系, 中点午线120°

罗盘高程系, 等高距为1米

2017版图式

1:1000



福州勘测院有限公司
注册测绘师: 陈兆勇
注册测绘师: 林松松
注册测绘师: 林松松
注册测绘师: 林松松

2867

40435.96